

JS140 | TRACKED EXCAVATOR



Engine Power : 75 KW (100HP), Bucket Capacity : 0.63-0.72 cu.m., Operating Weight : 13,560 kg





High durability : Heavy duty structures and durable high quality aggregates



High fuel economy : Savings of fuel costs upto Rs 1 lakh per year*



Best in class productivity
High speeds of operation



Low maintenance cost :
Hydraulic oil change interval : 5000 hours
Hydraulic filter change intervals : 500 hours



Enhanced operator comfort & Equipment safety: Vibration free cabin and ergonomic controls

TOP
5
BENEFITS FOR YOU



*T&C Apply.

EXCELLENT FUEL EFFICIENCY



Choice of two power modes:
Economy (E) & Productivity (P)
E : For high fuel saving at optimal productivity
P : For higher output levels



Energy efficient hydraulics for lower fuel consumption



Auto idler for fuel saving during engine idling at high speeds



BEST IN CLASS PERFORMANCE

XCELLENT Digging



High operating weight of 13560 kg

Higher reach & excellent digging forces for high output especially in tough strata

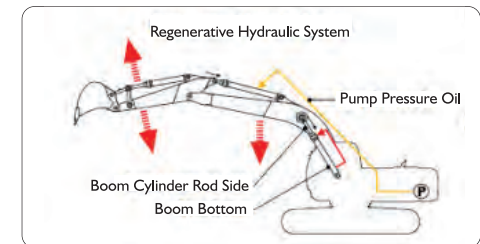

Regenerative circuits for higher operating speeds

*T&C Apply.

YOUR MOST RELIABLE PARTNER

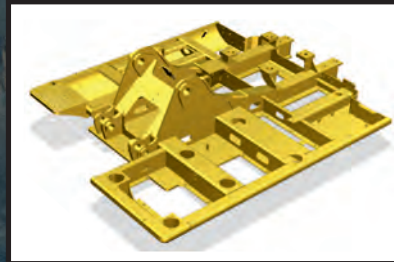

Rugged box section type construction of side frame for durability & protection from damage



Heavy duty X type track frame for durability. Side member designed to prevent material accumulation

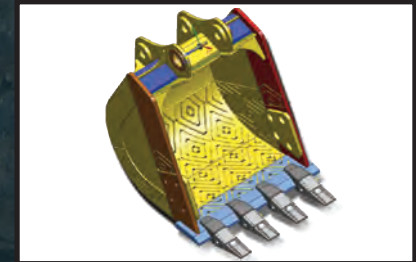

Optional heavy duty bucket with floating bush for easy gap adjustment to improve bush & pin life. Usage of Hardox steel for optional heavy duty hard faced bucket with reinforced hanger plates for high life.



Heavy duty arm : Reinforced boom joint and bucket joint area. Additional plate and ribs provided at bottom.

Reinforced boom: Single plates without weld joints for top & bottom plates with reinforced cylinder mounting area for high strength.

Brackets for mounting of breaker piping on boom & arm



Dust & water proof IP67 connectors



LOW MAINTENANCE COST



Plexus filtration system for high hydraulic oil & filter replacement intervals.
 Hydraulic filter : 500 hours & hydraulic oil : 5000 hours
(Subject to SOS & recommended maintenance practices)



Air pre-cleaner to increase air filter life

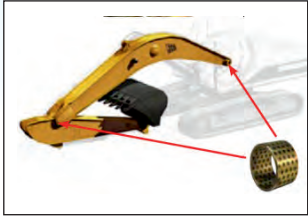

Graphite filled bushes on both ends of boom for high greasing intervals of 1000 hours



High capacity fuel pre-filter with water separator - to increase life of fuel system components

ULTIMATE EASE OF SERVICEABILITY



Easy to access periodic check points
 Side by side radiator & cooler for ease of maintenance



Optional HD bucket with floating bush for ease of adjustment of gap
 Enhanced bush & pin life



Compact & low profile engine bonnet supported by two gas struts for ease of opening





THE SAFEST CHOICE

Equipment protection system: Audio & visual alerts provided in instrument panel for following:

Air filter blockage



Low coolant level



High hydraulic oil temperature



Damage protection:
Belly guard at lower frame
& undercovers for upper frame



Anti-slip arrangement on machine top covers
Low bonnet design for high visibility at rear of machine



A COMFORTABLE OPERATOR IS A PRODUCTIVE OPERATOR



Comfortable fully adjustable deluxe seat
Ergonomically placed operator controls



Vibration free cabin: Mounted on viscous mounts to absorb vibrations
Well ventilated cabin: sliding windows (left hand side, right hand side & rear)



Servo lock lever override & slew lock system



Adjustable monitor panel with clear display

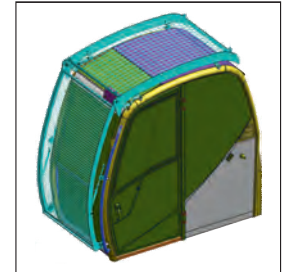

Provision for cab guard mounting (Front & Top)



High all around visibility aided by roof mounted glass for working at height



GROSS ENGINE POWER : 100 hp
 MAX. OPERATING WEIGHT : 13560 kgs

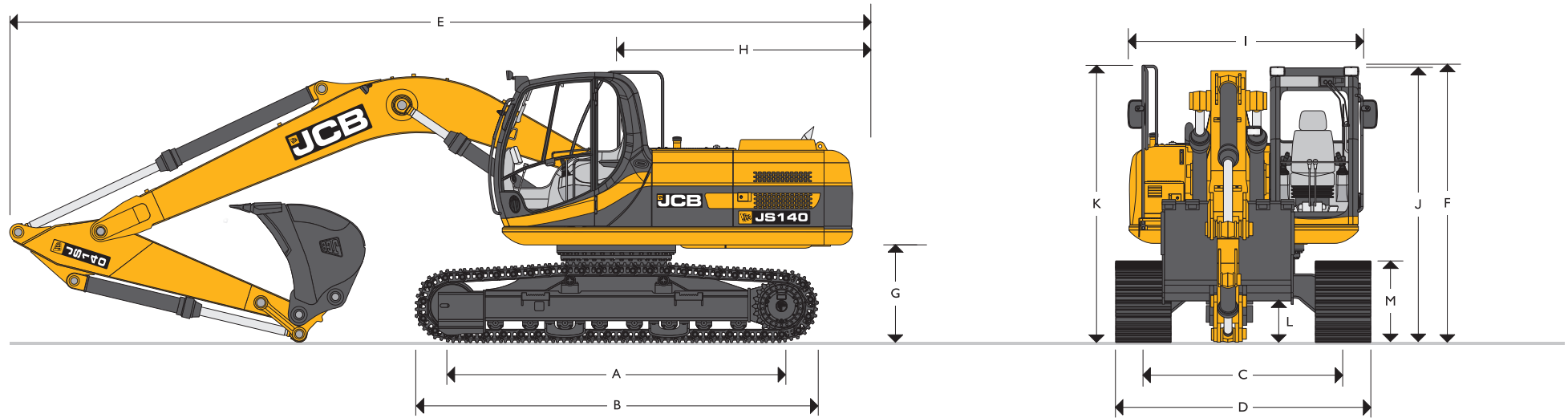

STATIC DIMENSIONS

	mm (ft-in)		mm (ft-in)
A Track length on ground	2780 (9-1)	H Tail swing radius	2150 (6-9)
B Undercarriage overall length	3550 (11-8)	I Width of superstructure	2410 (7-11)
C Track gauge	1990 (6-6)	J Height over cab	2755 (9-1)
D Width over tracks (500 mm trackshoes)	2490 (8-2)	K Height over grab rail	2874 (9-5)
	2.1m(dipper)	L Ground clearance	460 (1-6)
E Transport length with Monoboom	7630 (25-0)	M Track height	815 (2-8)
F Transport height with Monoboom	2874 (9-6)		
G Counterweight clearance	910 (3-0)		
		* Machine in transport position	

* All dimensions, weights and timings are variable within 1.5% JCB reserves the right to change specifications without prior notice.

WORKING RANGE

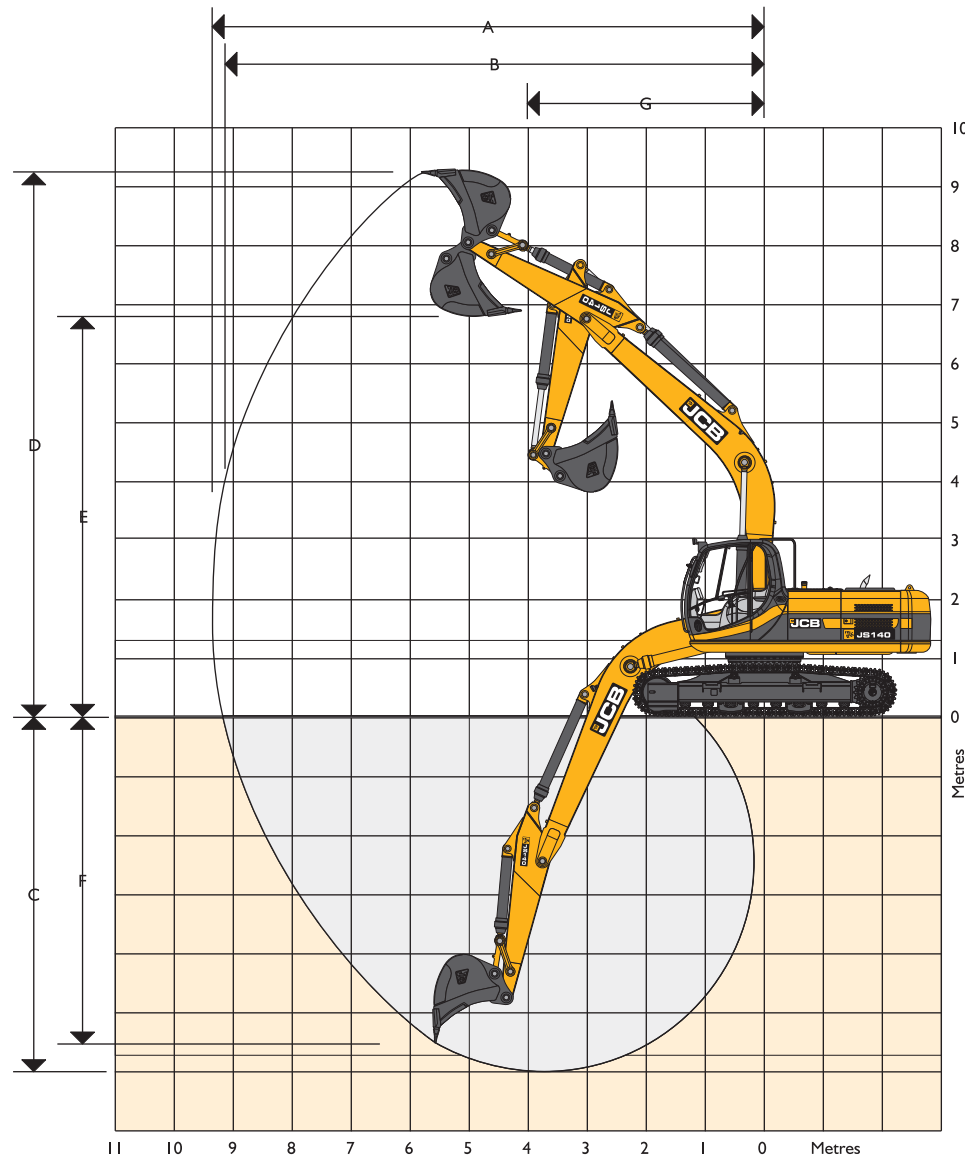

Boom length: 4.70m		
Dipper length: 2.10m (Standard)		
A	Maximum digging reach	mm (ft-in) 7970 (26-2)
B	Maximum digging reach (on ground)	mm (ft-in) 7820 (25-8)
C	Maximum digging depth	mm (ft-in) 5150 (16-11)
D	Maximum digging height	mm (ft-in) 8820 (28-11)
E	Maximum dumping height	mm (ft-in) 6430 (21-1)
F	Maximum vertical wall cut depth	mm (ft-in) 4580 (15-0)
G	Maximum swing radius	mm (ft-in) 2050 (6-9)
	Bucket rotation	182°
	Maximum dipper tear out (ISO 6015)	kgf (ibf) 7404 (16569)
	Maximum bucket tear out (ISO 6015)	kgf (ibf) 9785 (20667)



* All dimensions, weights and timings are variable within 1.5% JCB reserves the right to change specifications without prior notice.

ENGINE

Model	: Cummins 4BT 3.9C.
Type	: Water Cooled, 4 stroke, 4-cylinder in line, direct injection, turbo-charged.
Net Power	: (SAE J1995) 92hp at 2200 RPM
Piston	: 3.9 litres.
Displacement	
Air filtration	: Dry element with secondary safety element
Cooling	: Water cooler via large capacity radiator with anti block 'wavy' fins.
Starting system	: 24 volt.
Batteries	: 2 x 12 volt. Heavy Duty.
Alternator	: 24 volt. 45 amp.

CAB

Press steel with high strength rolled section frame. Excellent digging, loading and positioning visibility. Parallelogram wiper option. Fresh air ventilation and operator faces fan. Fully adjustable deluxe suspension seat with arm rest adjustment and backrest recline.

CONTROLS

Excavator	: All servo lever operated to ISO control pattern, independently adjustable to the seat.
Tracks	: Individually servo operated by foot pedal or hand lever.
Auxiliary	: Via servo operated foot pedal.
Horn	: Operated via servo lever mounted button.

FORCES

Unmatched digger forces enable faster cycle time.

Bucket tear out force.	9785 kgf
Arm digging forces.	7404 kgf

EXCAVATOR END

Monoboom is available on the JS 140 with a 2.10 m dipper as a standard fitment. Reserve strength is built into the fully welded structures for hydraulic hammer and other arduous operations.

EXCAVATOR BUCKET

All buckets are JCB type fully welded steel, with sealed, hardened steel pivot pins and replaceable wear parts.

Bucket size	Capacity
Max. width toe plate	
937mm	0.63 cu.m.(GP)
1071mm	0.72 cu.m.(GP)

HYDRAULIC SYSTEM

A variable flow load sensing system with flow on demand, variable power output and servo operated, multi-function open centre control.

2Work modes: P:Productivity & E:Economy

Main pumps	: 2 variable displacement axial piston type.
Maximum flow	: 2 x 130 L/min.
Servo pump	: Gear type
Maximum flow	: 20 L/min

Control valve

A combined four and five spool control valve with auxiliary service spool as standard. When required twin pump flow is combined to boom, dipper and bucket services for greater speed and efficiency.

Relief valve settings

Boom / Arm / Bucket	330 bar
Swing circuit	279 bar
Travel circuit	330 bar
Pilot control	40 bar

FILTRATION SYSTEM

The hydraulic components are protected by the highest standard of filtration to ensure long hydraulic fluid life upto 5000 hrs (subject to SOS & recommended maintenance practices) and component life.

In tank : 150 micron, suction strainer.

Main return line	: 10 micron, fibre form element.
Plexus Bypass line	: 1.5 micron, paper element.
Pilot line	: 10 micron, paper element.

Hydraulic hammer return : 10 micron, reinforced microform element.

Cooling

Worldwide cooling is provided via a full return line air blast cooler with anti-block wavy cooling fins.

SWING SYSTEM

Swing motor	: Axial piston type
Swing brake	: Hydraulic braking plus, automatic spring applied disc type parking brake.
Final drive	: Planetary reduction
Swing gear	: Large diameter, internally toothed fully sealed grease bath lubricated.
Swing speed	: 13.6 RPM.

UNDERCARRIAGE

Construction : Fully welded. "X" frame type with central belly guarding and sloping sidemembers with dirt relief holes under top rollers.

Track Shoe	: 500mm (Standard)
Upper & lower rollers	: Heat treated, sealed and lubricated.
Track adjustment	: Grease cylinder type.
Track idler	: Sealed and lubricated, with spring enhanced recoil.
No. of track guides	1 per side
No. of lower rollers	7 per side
No. of upper rollers	1 per side
No. of track shoes	44 per side

TRACK DRIVE

Type : Fully hydrostatic

Travel motors : Axial piston type, fully guarded within undercarriage frame.

Final Drive : Planetary reduction, bolt-on sprockets

Service brake : Hydraulic counter balance valve to prevent overspeeding on gradients.

Park brake : Disc type, spring applied, automatic hydraulic release.

Gradeability	: 70% (35 deg.) continuous
Travel Speed	: 3.8 kmph
Tractive effort	: 102.6 KN (10458 kgf)

TRAVEL SPEED & TRACTIVE EFFORT

Travel speed	3.8 km/h
Tractive Force	10458 Kgf

WEIGHT AND GROUND BEARING PRESSURE

Standard machine with bucket, operator

Full capacity lubes and fuel

Operating Weight	13560 kg
Ground bearing pressure	0.49 kg/sq.cm







STANDARD / OPTIONAL EQUIPMENT

Auto idler	Std
Heavy-Duty Dipper	Std
Heavy-Duty Boom	Std
Air pre-cleaner	Std
Engine fan guard	Std
Double element air cleaner	Std
Electric isolator	Std
Interior Light	Std
Cabin Fan	Std
Operator's storage space	Std
Plexus hydraulic oil filtration	Std
Rock breaker pipe work mounting brackets	Std
Work lights-boom & mainframe mounted	Std
Undercarriage belly guarding	Std
Upper structure under covers	Std
Tool kit & storage area	Std
Handrail & nonslip walk ways	Std
Windscreen wiper	Opt
General purpose buckets	Opt
Rock breaker	Opt
Rock breaker pipe work	Opt
Cab mounted & rear work lights	Opt
Heavy-Duty Bucket	Opt
First aid kit	Opt
Fire extinguisher	Opt
Cab guard (Front & Top)	Opt

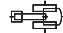
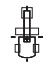
SERVICE CAPACITIES

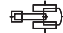

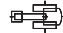
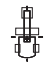
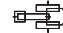
Fuel tank	253 lt
Engine Coolant	21.2 lt
Engine oil	9.0 lt
Swing reduction gear	2.2 lt
Track reduction gear (each side)	3.0 lt
Hydraulic system	124.0 lt
Hydraulic tank	73.0 lt

* All dimensions, weights and timings are variable within 1.5% JCB reserves the right to change specifications without prior notice.

Reach	3 m		4.5 m		6.0 m		7.5 m		Capacity at Max. Reach		
Load Point Height											m

LIFT CAPACITIES - Dipper length : 2.1m, 4.7m Monoboom, Trackshoes: 500mm, No bucket

Load Point Height	1.5m		3m		4.5m		6m		7.5m		Max Reach
	F&R	FC	F&R	FC	F&R	FC	F&R	FC	F&R	FC	F&R
7.5m	-	-	3615*	3615*	-	-	-	-	-	-	-
6m	-	-	-	-	3129*	3129*	-	-	-	-	-
4.5m	-	-	3724*	3724*	3300*	3300*	2782*	2497	-	-	-
3m	-	-	5827*	5827*	4001*	3767	3281	2452	-	-	2889
1.5m	-	-	-	-	4813*	3547	3190	2367	-	-	2833
0m	-	-	5518*	5518*	4738	3408	3121	2302	-	-	2788
-1.5m	4933*	4933*	7819*	6178	4699	3373	3117	2299	-	-	-
-3.0m			6608*	6312	4476*	3447	-	-	-	-	-
-4.5m	-	-	-	-	-	-	-	-	-	-	-

-  Lift capacity front and rear
-  Lift capacity full circle

Notes: • For lifting capacity including bucket, subtract total weight of bucket or bucket and quicktich from above value • The above loads are in compliance with SAE and ISO standards i.e. 75% of minimum tipping load or 87% of hydraulic lift capacity, whichever is less. Lifting capacities marked * are based on hydraulic capacity • Lift capacities assume that the machine is on firm, level ground • Lift capacities may be limited by local regulations. Please refer to your dealer.



* All dimensions, weights and timings are variable within 1.5% JCB reserves the right to change specifications without prior notice.

World class state-of-the-art manufacturing facility at Pune



India's best & largest dealer network



Dealer :

India's Largest Manufacturer of Construction Equipment

JCB INDIA LIMITED : 23/7 Mathura Road, Ballabgarh - 121 004 Haryana, India.
Tel. : + 91 129 4299000 Fax : +91 129 2309050 E-mail : delhi.marketing@jcb.com Website : www.jcb.com